

Orlando International Airport  
5855 Cargo Road  
Orlando, Florida 32827-4349

October 6, 2022

Magical Cruise Line Ltd., dba Disney Cruise Line  
Jose Fernandez  
P.O. Box 10210  
Lake Buena Vista, FL 32880

**Re: This Amendment One to Space/Use Agreement dated January 1, 2022, by and between Greater Orlando Aviation Authority (“Aviation Authority”) and Magical Cruise Line, Ltd, dba Disney Cruise Line (“Company”) (the “Amendment”)**

**Effective October 01, 2022**

Dear Mr. Fernandez:

Reference is made to the Space/Use Agreement dated January 1, 2022, (the "Agreement"), by and between the Aviation Authority and Company. Capitalized terms contained in this letter and not otherwise defined herein shall have the definitions contained in the Agreement.

As per Paragraph A-1 of the Agreement, the Company occupies certain space on Landside Terminal B, Level 1 (the “Occupied Space”) in order to provide for the operations at the airport. Pursuant to Paragraph 10 of the Agreement, amendments thereto may be made by revising Attachment A and Exhibit B and executing a dated letter of amendment. As such, the Authority and Company hereby agree to amend the Agreement to change items A-1, A-2, A-5 and A-6 of Attachment A and Exhibit B, subject to the terms and conditions set forth in this Amendment.

Enclosed please find a revised Attachment A, Exhibit A-1 and Exhibit B setting forth the revised terms, conditions and spaces of the Agreement. All other provisions of the Agreement not changed by this Amendment shall remain in full force and effect and shall be binding upon the parties.

Please indicate your agreement to the forgoing on behalf of the company by signing this amendment in the space provided below.

ACCEPTED AND AGREED TO:

**GREATER ORLANDO  
AVIATION AUTHORITY**

By:   
Name: Kevin J. Thibault P.E., F.ASCE  
Title: Chief Executive Officer  
Date: 11/11/2022

**MAGICAL CRUISE LINE LTD  
dba Disney Cruise Line**

By:   
Printed Name: Jose I. Fernandez  
Title: VP Port Strategy & Ops  
Date: 10/28/2022

ATTEST:

By:   
Anna Farmer  
Manager, Board Services



**ATTACHMENT A**  
**AMENDMENT ONE TO SPACE USE AGREEMENT**  
**MAGICAL CRUISE LINE LTD**  
**dba Disney Cruise Line**

**A-1. SPACE TO BE OCCUPIED.**

Refer to Exhibit A-1 attached hereto and incorporated herein by this reference.

<u>Location</u>	<u>Class</u>	<u>Sales Tax</u>	<u>S.F.</u>	<u>Rate P.S.F.</u>	<u>Annual Rate</u> (Applicable sales tax not included)	<u>Monthly Rate</u> (Applicable sales tax not included)
LS, Level 1	Enclosed	6.0%	590.0	\$193.21	\$113,993.90	\$9,499.49
LS, Level 1	Enclosed	6.0%	480.0	\$193.21	\$92,740.80	\$7,728.40
<b>Total:</b>			<b>1,070.0</b>	<b>\$193.21</b>	<b>\$206,734.70</b>	<b>\$17,227.89</b>

**A-2. SPACE RENTAL CHARGE.**

Refer to Exhibit B attached hereto and incorporated herein by this reference.

**ANNUAL      \$206,734.70                      MONTHLY      \$17,227.89**

**A-3. TERM.**

This section remains unchanged by this Amendment.

**A-4. INSURANCE REQUIREMENTS.**

This section remains unchanged by this Amendment.

**A-5. SECURITY DEPOSIT**

Refer to Exhibit B attached hereto and incorporated herein by this reference.  
**\$54,784.70**

**A-6. TURN-IN FEE**

Refer to Exhibit B attached hereto and incorporated herein by this reference.  
**\$3,477.50**

**A-7. UTILITY & SERVICE CHARGES.**

This section remains unchanged by this Amendment.

**A-8. SPECIAL CONDITIONS**

This section remains unchanged by this Amendment.

**EXHIBIT A-1**

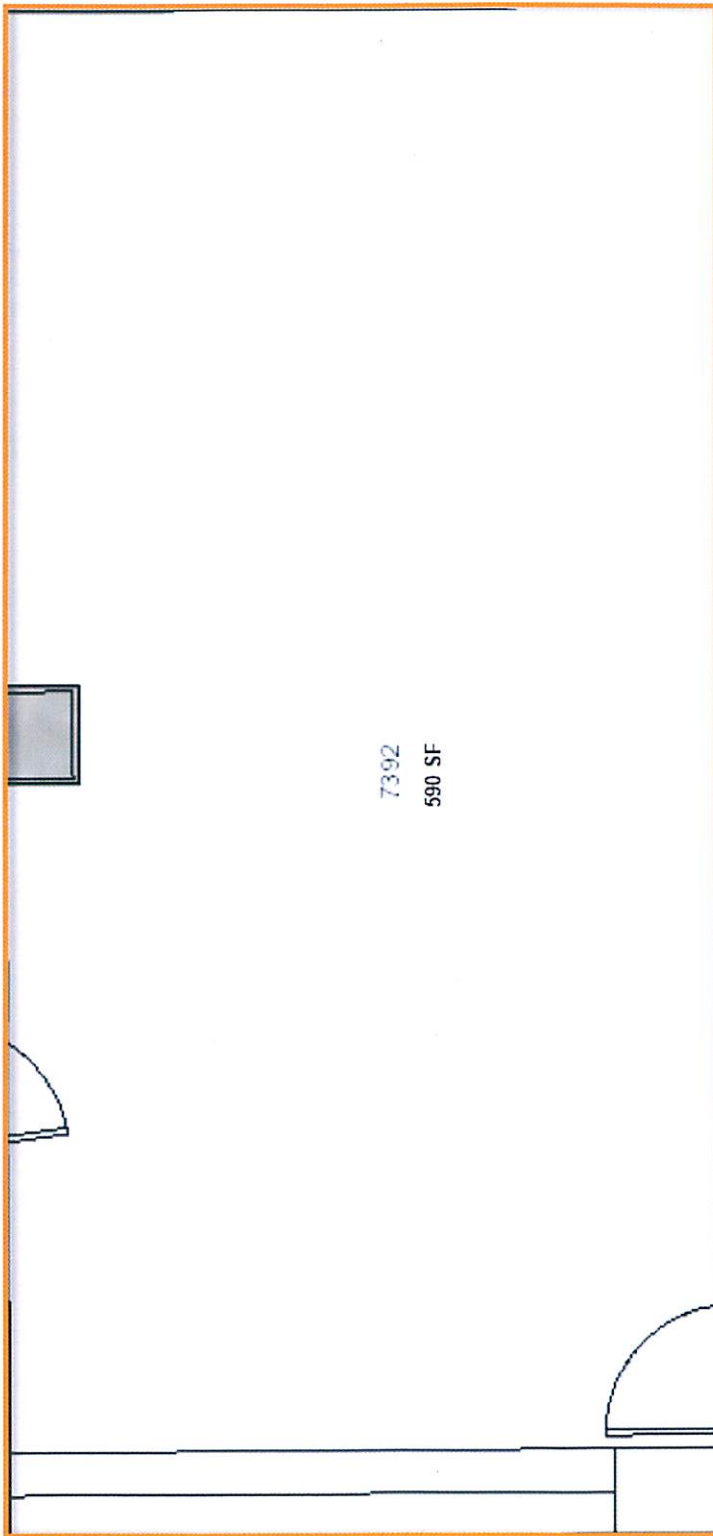

**Greater Orlando  
Aviation Authority**

“MCO”  
Orlando International  
Airport

**SPACE USE  
AGREEMENT**

EXHIBIT A-1

TERMINAL B  
LANDSIDE

ZONE SOUTHWEST  
LEVEL 01

**ROOM ID'S:**  
OIA.0800.NTLS.ZSW.01.7392

Not to Scale

A.

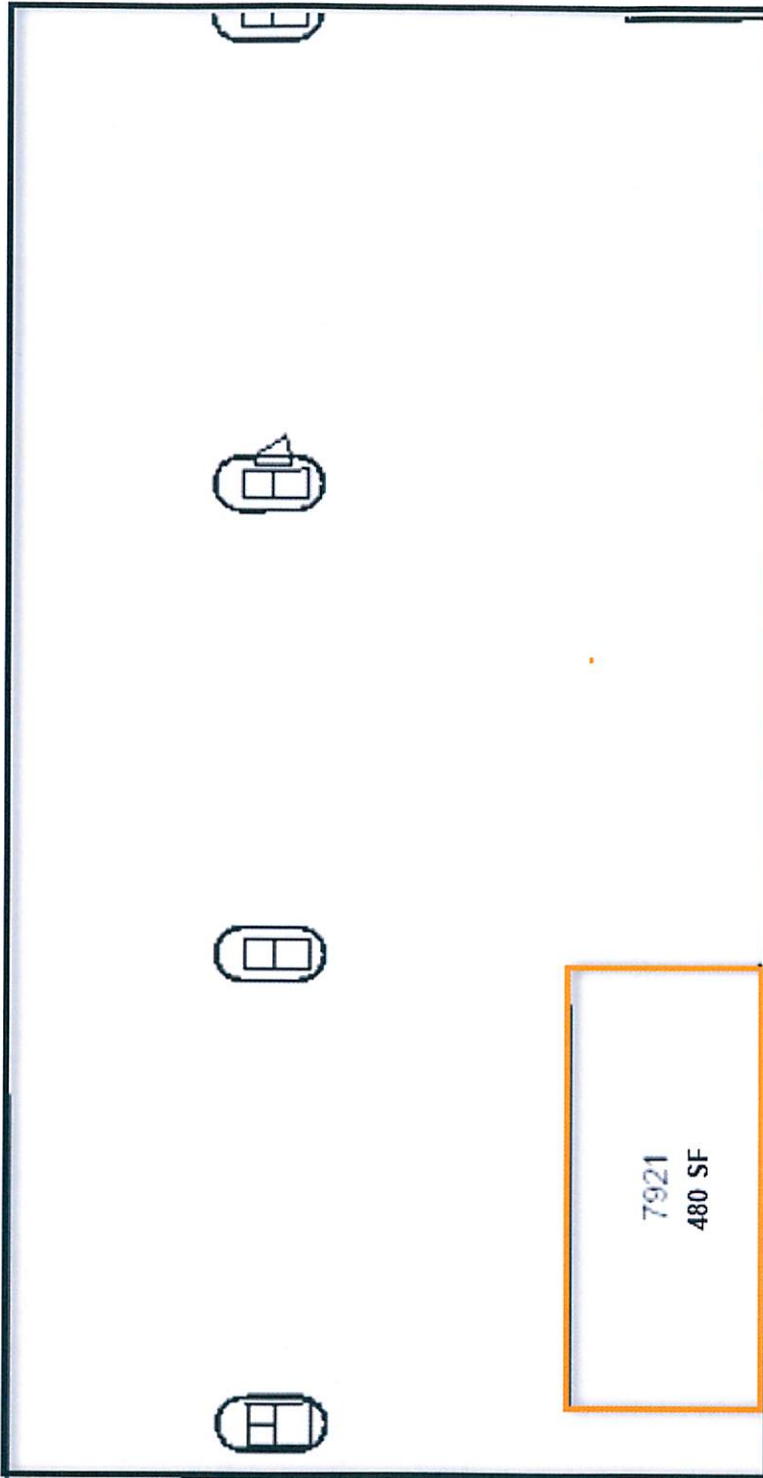

**Greater Orlando  
Aviation Authority**

“MCO”  
Orlando International  
Airport

**SPACE USE  
AGREEMENT**

EXHIBIT A-1

TERMINAL B  
LANDSIDE

ZONE SOUTHWEST  
LEVEL 01

ROOM ID'S:  
OIA.0800.NTLS.ZSW.01.7921

Not to Scale

**EXHIBIT B**  
**Space Use Agreement**  
**MAGICAL CRUISE LINE, LTD.**

Rental Rates PSF - FY 2022-2023 effective  
10/01/2022

Enclosed	Unenclosed
\$193.21	\$3.00

A - 1 Space to be Occupied				SF by Class of Space			Rent (Applicable Sales Tax Not Included)	
Location	SF	Effective Date	Sales Tax	Enclosed	Unenclosed	Other	Annual Charge	Monthly Charge
OIA.0800.NTLS.ZSW.01.7392 (Office)	590.0	10/1/2022	Y	590.0			\$113,993.90	\$9,499.49
OIA.0800.NTLS.ZSW.01.7921 (DCL Counter)	480.0	10/1/2022	Y	480.0			\$92,740.80	\$7,728.40
<b>Total</b>				<b>1,070.0</b>	<b>0.0</b>	<b>0.0</b>	<b>\$206,734.70</b>	<b>\$17,227.89</b>

<b>A - 2 Space Rental Charge</b>	<i>Amounts may vary slightly due to rounding when entered into financial billing system</i>	<b>\$206,734.70</b>	<b>\$17,227.89</b>
<b>A - 5 Security Deposit</b>			<b>\$54,784.70</b>
<b>A - 6 Turn-in Fee</b>			<b>\$3,477.50</b>

A